

# EUROPE

## Luxury River Cruising and Touring

### 2010 EARLYBIRDS



**^ FREE AIRFARE TO EUROPE**  
**Just pay taxes from \$700** PER PERSON  
**SAVE UP TO \$3790** PER COUPLE

**AVAILABLE ON ALL CRUISES 15 DAYS AND OVER FROM MARCH TO NOVEMBER**

**SINGAPORE AIRLINES**

A great way to fly



# Scenic "Space-Ships" The Ultimate River Cruising Experience

Over the past years I have spoken to a great number of our guests who had sailed on river cruise ships we had chartered. Their feedback was invaluable and enabled me to form a clear vision of how our ships should be designed. On arriving in Europe on the 5th of January 2007 I had only one goal in mind – to build the Ultimate River Cruising ship for Australian travellers. So the project commenced and the first Scenic "Space-Ship" entered service in July 2008. Australian's typically cruise on Europe's waterways for 14 to 21 nights and as such appreciate greater public space and larger cabins. We designed our "Space-Ships" to be 135 metres in length, increasing the size of all public areas and ensuring that all guests could be comfortably accommodated in the Restaurant in one sitting. We also added a second Restaurant – our now famous Portobello's fine dining Italian. And finally, we increased the size of our cabins by 25% over average River Cruise cabins so we could include full size Private Balconies.

But we didn't stop there. I realised after meeting many of our guests that the Scenic "Space-Ship" cruising experience had to be TRULY all inclusive... so we added little touches like free Cappuccino or Espresso from your own self service machine to complimentary quality bottled wine with both lunch and dinner. All meals are included as well as dining at the magnificent Portobello's at no extra cost. We included ALL excursions including our renowned Scenic FreeChoice and new Scenic Enrich programs – not sold as optional extras at additional cost – so our guests could be certain once they came on board there was little or nothing more to pay for.

So I was really pleased to hear from a couple on their last day in Amsterdam tell me they had spent just \$160 for the entire 15 days including souvenirs. They made the comment they'd spent more than that in one day on previous cruises!

Our fleet has grown to 4 ships, Scenic Emerald, Sapphire, Ruby and Diamond – all proudly 100% owned and operated by Scenic Tours. For 2010 we have created some super savings for Earlybird bookings, so I urge you to book early to take advantage of these special offers.

We look forward to welcoming you on board.



Best Regards,

Glen Moroney

Founder and Managing Director, Scenic Tours

## ONLY SCENIC TOURS RIVER CRUISES OFFER THIS FULL RANGE OF FEATURES AND BENEFITS – MANY EXCLUSIVE

- **EUROPE'S NEWEST LUXURY FLEET**  
Scenic Tours have the newest and most modern fleet on Europe's waterways with 4 luxurious river cruise ships constructed in 2008 & 2009
- **PRIVATE OUTDOOR BALCONIES**  
Scenic Tours are the only company to offer Private Outdoor Balconies, available on all cabins on the top two decks – 82% of total cabins
- **THE MOST SPACIOUS SUITE**  
Scenic Tours Private Balcony Suites are 24% larger than comparable river cruise cabins
- **RELAX ON YOUR OUTDOOR BALCONY**  
Only Scenic Tours offer outdoor teak balconies furnished with table and chairs **Exclusive to Scenic Tours**
- **EXCLUSIVE PRIVATE BUTLER SERVICE**  
Enjoy Private Butler service in Royal and Junior Suites and on all Balcony Suites on the Danube Deck **Exclusive to Scenic Tours**
- **PORTOBELLO'S ITALIAN RESTAURANT**  
Only Scenic Tours offers a choice of two on board fine dining restaurants, Crystal Dining and the exclusive Portobello's Italian Restaurant **Exclusive to Scenic Tours**
- **100% AUSTRALIAN OWNED**  
Scenic Tours river cruises are 100% Australian owned and operated and specifically designed for the discerning Australian traveller **Exclusive to Scenic Tours**
- **MORE PUBLIC SPACE PER GUEST**  
Our spacious public areas are 20% larger than on most other vessels and we include a choice of 3 outdoor viewing areas. Our main restaurant, Crystal Dining, is up to 30% larger than typical river cruise ships **Exclusive to Scenic Tours**
- **FULLY INCLUSIVE CRUISING**  
All sightseeing and on board activities included – no optional extras to pay for
- **ALL MEALS INCLUDED**  
Starting with early riser breakfast, Scenic Tours include all meals on board including a full hot buffet breakfast, delicious buffet lunch with a-la-carte choices and a four course a-la-carte dinner
- **PREMIUM BOTTLED WINE INCLUDED**  
Complimentary wines are served with both lunch and dinner
- **ALL TIPPING AND GRATUITIES INCLUDED**  
All tipping and gratuities are included on the cruise and land portion of your holiday, **saving you up to \$800 per couple**
- **COMPLIMENTARY AIRPORT TRANSFERS**  
Complimentary exclusive airport transfers are included on the first and last day of your tour **valued at \$320 per couple**
- **ON BOARD ENTERTAINMENT**  
Enjoy our extensive program of on board entertainment from classical music to gypsy troupes
- **EXPERT CRUISE DIRECTOR**  
You will be served by the best and most experienced European Cruise Directors
- **ON BOARD INFOTAINMENT SYSTEM**  
Every stateroom and suite features a state-of-the-art on board infotainment system and flat screen TV
- **SCENIC SLUMBER BED**  
Every stateroom and suite features a deluxe queen size Scenic Slumber bed and pillow menu **Exclusive to Scenic Tours**
- **MAXIMUM LEISURE TIME**  
Our cruises dock in the heart of Europe's towns and cities, right where you want to be
- **COMPLIMENTARY BICYCLES**  
Our guests enjoy the use of complimentary bicycles for onshore exploration
- **PRIVATE CONCERT IN VIENNA**  
Over a glass of Austrian 'Sekt', enjoy a private concert of Viennese music at the opulent Palais Liechtenstein **Exclusive to Scenic Tours**
- **BRINGING AUSTRALIAN HISTORY TO LIFE**  
On selected departures our guests will enjoy lectures and commentary from members of Australia's renowned History Team **Exclusive to Scenic Tours**
- **EXCLUSIVE SCENIC ENRICH PROGRAM**  
Our guests will enjoy an exclusive range of extra events and activities **Exclusive to Scenic Tours**
- **SCENIC FREECHOICE**  
Tailor-make your activities with Scenic FreeChoice in Amsterdam, Würzburg, Passau and Vienna – all included at no extra cost

# PRIVATE BALCONY SUITES *Exclusive to Scenic Tours*



Only Scenic "Space-Ships" Private Balcony Suites offer your very own private outdoor area. PLEASE COMPARE THE BENEFITS OF A SCENIC "SPACE-SHIP" PRIVATE BALCONY SUITE

## Scenic "Space-Ship" Private Balcony Suite

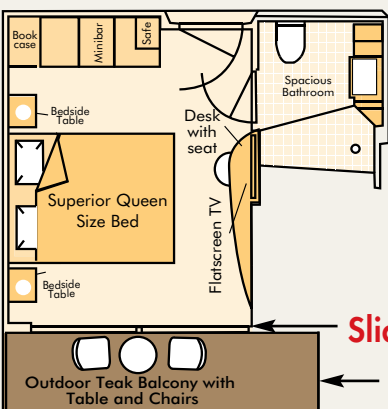

**EXCLUSIVE OUTDOOR BALCONY**  
 Featured on the entire Rhine and Danube Decks

- Size: 200 sq ft/18.5 m<sup>2</sup>
- Real OUTDOOR Balcony
- Teak Balcony furnished with teak table and chairs
- 24% larger than typical river cruise cabins

Sliding glass door  
 Outdoor Balcony

## Typical Competitors "Balcony" Cabin

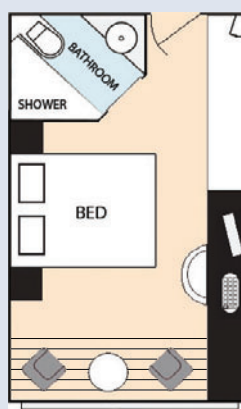

**NO OUTDOOR BALCONY**  
 Sometimes referred to as French Balconies or "All-weather Balconies"

- Size ranges from 150–170 sq ft / 13.9–15.8 m<sup>2</sup>
- "Balcony" is actually inside the cabin
- Sliding glass door only opens halfway - meaning one person is always sitting in front of glass
- No outdoor seating
- 24% smaller than Scenic Tours on average

Sliding glass door

# EARLYBIRD ONE

BOOK\* AND PAY IN FULL BY 31 AUGUST 2009

## TRAVEL IN 2010 AND PAY 2009 PRICES

Book and deposit any river cruise of 15 days and over or any river cruise of 15 days and over combined with land content for travel between April and October 2010 and cruise at 2009 prices. Full payment must be received by 31 August 2009. Port Charges additional from \$355.

# SUPERSAVER EARLYBIRD

BOOK\* BY 30 SEPTEMBER 2009

# EARLYBIRD SAVER

BOOK\* BY 30 NOVEMBER 2009

<b>FREE AIRFARE</b> JUST PAY TAXES FROM \$700 PER PERSON SAVE UP TO \$3790 PER COUPLE	<b>PARTNER</b> FREE AIRFARE JUST PAY TAXES FROM \$700 PER PERSON SAVE UP TO \$1895 PER COUPLE	<b>\$ DOLLAR</b> SAVING PER COUPLE	<b>SAVE</b> \$2000 PER COUPLE MAY TO SEPTEMBER DEPARTURES ONLY	<b>SAVE</b> \$1000 PER COUPLE	<b>\$ DOLLAR</b> SAVING PER COUPLE
<b>ALL DEPARTURES</b>					

<b>E&amp;D STATEROOMS ONLY</b> EXCLUDES ITINERARIES CONTAINING A 7 NIGHT CRUISE	<b>PRIVATE BALCONIES, JUNIOR &amp; ROYAL SUITES</b>	<b>PRIVATE BALCONIES, JUNIOR AND ROYAL SUITES</b> ON TOURS COMBINED WITH A CRUISE	<b>E&amp;D STATEROOMS</b> EXCLUDES ITINERARIES CONTAINING A 7 NIGHT CRUISE	<b>PRIVATE BALCONIES, JUNIOR &amp; ROYAL SUITES</b>	<b>PRIVATE BALCONIES, JUNIOR &amp; ROYAL SUITES</b> ON TOURS COMBINED WITH A CRUISE
---	---	--	--	---	--

EUROPE RIVER CRUISING + DELUXE CITY STAYS	TOUR CODE	PAGE						
21 Day Paris + Amsterdam to Budapest Cruise + Prague	PACP	30	✓	✓ May to Sep	×	✓	✓ May to Sep	×
18 Day Paris + Amsterdam to Budapest Cruise	PACR	30	✓	✓ Apr & Oct	\$1000 May to Sep	✓	×	\$500 Apr to Oct
18 Day Amsterdam to Budapest Cruise + Prague	CRPR	30	✓	✓ Apr & Oct	\$1000 May to Sep	✓	×	\$500 Apr to Oct
21 Day London + Amsterdam to Budapest Cruise + Prague	LCPR	32	✓	✓ May to Sep	×	✓	✓ May to Sep	×
18 Day London + Amsterdam to Budapest Cruise	LOCR	32	✓	✓ Apr & Oct	\$1000 May to Sep	✓	×	\$500 Apr to Oct
15 Day Amsterdam to Budapest Cruise	STC	34	✓	✓ Apr & Oct	\$500 May to Sep	✓	✓ Apr & Oct	\$250 May to Sep
30 Day Amsterdam to the Black Sea Cruise + Gallipoli	ABBI	36	✓ Apr & May	×	×	✓	×	×
24 Day Amsterdam to the Black Sea Cruise	ABBU	36	✓ Apr & May	×	×	✓	×	×
11 Day Gems of the Danube Cruise	PNB	39	Partner Free Airfare only	×	\$500	SAVE \$1000 per couple	×	\$250
18 Day Black Sea Explorer Cruise + Gallipoli	BUIS	40	Partner Free Airfare only	×	\$500	SAVE \$1000 per couple	×	\$250
12 Day Black Sea Explorer Cruise	BUBC	40	Partner Free Airfare only	×	\$500	SAVE \$1000 per couple	×	\$250
23 Day Amsterdam to Budapest Cruise + ANZAC Day Turkey	ANZC	42	✓	✓	×	✓	✓	×
<b>2010 PASSION PLAY OBERAMMERGAU RIVER CRUISING &amp; TOURING</b>								
26 Day Grand Alpine, Passion Play + Budapest to Amsterdam Cruise	OBGA	46	✓	✓	×	✓	✓	×
11 Day Grand Alpine and Passion Play	OBGL	46	×	×	\$660	×	×	\$330
28 Day Rome to Budapest, Passion Play + Budapest to Amsterdam Cruise	OBRB	50	✓	✓	×	✓	✓	×
12 Day Rome to Budapest and Passion Play	OBRL	50	×	×	\$765	×	×	\$385
18 Day Bavarian Highlights, Passion Play + Amsterdam to Budapest Cruise	OBER	54	✓	×	\$1000	✓	×	\$500
21 Day Bavarian Highlights, Passion Play + Amsterdam to Budapest Cruise + Paris or Prague	OBER	54	✓	✓	×	✓	✓	×
19 Day Alpine Highlights, Passion Play + Budapest to Amsterdam Cruise	OBAI	56	✓	×	\$1000	✓	×	\$500
22 Day Alpine Highlights, Passion Play + Budapest to Amsterdam Cruise + Paris	OBAI	56	✓	✓	×	✓	✓	×
21 Day Bohemian Sojourn, Passion Play + Budapest to Amsterdam Cruise	OBBS	58	✓	×	\$1000	✓	×	\$500
24 Day Bohemian Sojourn, Passion Play + Budapest to Amsterdam Cruise + Paris	OBBS	58	✓	✓	×	✓	✓	×
11 Day Bavarian Grandeur, Passion Play + Gems of the Danube Cruise	OBEN	60	Partner Free Airfare only	×	\$500	SAVE \$1000 per couple	×	\$250
12 Day Alpine Highlights, Passion Play + Gems of the Danube Cruise	OBAN	61	Partner Free Airfare only	×	\$500	SAVE \$1000 per couple	×	\$250
14 Day Bohemian Odyssey, Passion Play + Gems of the Danube Cruise	OBBN	61	Partner Free Airfare only	×	\$500	SAVE \$1000 per couple	×	\$250
<b>CHRISTMAS AND NEW YEAR CRUISE</b>								
16 Day Christmas and New Year Cruise Departure Date: December 21	CHAA	64	✓	×	×	✓	×	×
<b>EASTERN EUROPE &amp; DALMATIA + RIVER CRUISING</b>								
12 Day Eastern Europe Explorer	EEE	66	×	×	\$545	×	×	\$545
24 Day Eastern Europe Explorer + Budapest to Amsterdam Cruise	EESC	69	✓	✓	×	✓	✓	×
14 Day Dalmatia Discovery	DICD	70	×	×	\$750	×	×	\$750
26 Day Amsterdam to Budapest Cruise + Dalmatia Discovery	DICC	73	✓	✓	×	✓	✓	×
<b>BRITAIN &amp; IRELAND + RIVER CRUISING</b>								
21 Day Britain and Ireland	BAIL	74	×	×	\$970	×	×	\$970
35 Day Britain and Ireland + Amsterdam to Budapest Cruise	BAIC	77	✓	✓	×	✓	✓	×
11 Day Essence of Ireland	IREL	78	×	×	\$540	×	×	\$540
25 Day Essence of Ireland + Amsterdam to Budapest Cruise	IREC	81	✓	✓	×	✓	✓	×

✓ Applicable × Not Applicable Earlybird discounts cannot be combined

\*AND PAY APPLICABLE DEPOSIT. STRICTLY LIMITED CABINS AVAILABLE ON SET DEPARTURES OR UNTIL SOLD OUT. PLEASE READ IN CONJUNCTION WITH SCENIC TOURS 2010 EUROPE BROCHURE. EARLYBIRD DISCOUNTS AND SUPER SEASONAL SPECIALS CANNOT BE COMBINED AND NO OTHER DISCOUNT APPLIES.

# SUPER SEASONAL SPECIALS

BOOK\* FOR TRAVEL AT THESE TIMES AND RECEIVE THESE SUPER SPECIALS

JUST CHOOSE YOUR PREFERRED CRUISE OR CRUISE AND TOUR AND SEE THE APPLICABLE SPECIAL OFFERS		<b>FREE AIRFARE</b> JUST PAY TAXES FROM \$700 PER PERSON	<b>FLY BUSINESS CLASS FOR</b> \$2600 PER PERSON <small>BASED ON SWISS INT. AIRLINE</small>	<b>FLY BUSINESS CLASS FOR</b> \$3600 PER PERSON <small>BASED ON SWISS INT. AIRLINE</small>	<b>FREE ASIA STOPOVER +</b> FREE AIRFARE JUST PAY TAXES FROM \$700 PER PERSON
TOUR CODE		PRIVATE BALCONIES, JUNIOR & ROYAL SUITES	WHEN YOU PURCHASE A ROYAL SUITE	WHEN YOU PURCHASE A P CAT. CABIN AND ABOVE	AVAILABLE ON ALL CABIN CATEGORIES
21 Day Paris + Ams-Bud Cruise + Prague	PACP	✓ Mar, Apr, Oct & Nov	✓ Mar & Nov	✓ Apr & Oct	✓ Mar & Nov
18 Day Paris + Ams-Bud Cruise	PACR	✓ Mar & Nov	✓ Mar & Nov	×	×
18 Day Ams-Bud Cruise + Prague	CRPR	✓ Mar & Nov	✓ Mar & Nov	×	×
21 Day London + Ams-Bud Cruise + Prague	LCPR	✓ Mar, Apr, Oct & Nov	✓ Mar & Nov	✓ Apr & Oct	✓ Mar & Nov
18 Day London + Ams-Bud Cruise	LOCR	✓ Mar & Nov	✓ Mar & Nov	×	×
15 Day Ams-Bud Cruise	STC	✓ Mar & Nov	✓ Mar & Nov	×	×
30 Day Ams-Black Sea Cruise + Gallipoli	ABBI	✓ Apr & May	×	×	×
24 Day Ams-Black Sea Cruise	ABBU	✓ Apr & May	×	×	×
16 Day Christmas and New Year Cruise	CHAA	✓ 21 Dec	×	×	×

## SWITZERLAND, AUSTRIA & THE ALPS + RIVER CRUISING

	TOUR CODE	PAGE
14 Day Grand Alpine Adventure	SSAL	82
26 Day Grand Alpine Adventure + Budapest to Amsterdam Cruise	SSAC	85
12 Day Switzerland & Italian Lakes	SWIL	86
26 Day Switzerland, Italian Lakes + Amsterdam to Budapest Cruise	SWIC	89

## GRAND EUROPE + RIVER CRUISING

	TOUR CODE	PAGE
22 Day Grand European	GRAN	90
36 Day Grand European + Amsterdam to Budapest Cruise	GRAC	93

## FRANCE + RIVER CRUISING

	TOUR CODE	PAGE
15 Day France's Finest	FRFI	94
29 Day France's Finest + Amsterdam to Budapest Cruise	FRFC	97
20 Day Battlefields of France + Amsterdam to Budapest Cruise	BFCR	98
23 Day Battlefields of France + Amsterdam to Budapest Cruise + Prague	BFCR	98
19 Day Dawn Service Battlefields of France + Amsterdam to Budapest Cruise	BFCR.1	99

## ITALY + RIVER CRUISING & OCEAN CRUISING

	TOUR CODE	PAGE
17 Day Rome to Budapest	ITE	100
29 Day Rome to Budapest + Budapest to Amsterdam Cruise	ITEC	103
14 Day Grand Tour of Italy	ITA	104
23 Day Grand Tour of Italy and Roman Empire Cruise	ITAR	104

## TURKEY & GREECE + RIVER CRUISING

	TOUR CODE	PAGE
15 Day Treasures of Turkey	TURK	108
29 Day Treasures of Turkey + Budapest to Amsterdam Cruise	TUSC	111
21 Day Greece and Turkey	GRTU	112
35 Day Greece and Turkey + Budapest to Amsterdam Cruise	GRTC	115

## SPAIN, PORTUGAL & MOROCCO + RIVER CRUISING

	TOUR CODE	PAGE
16 Day The Best of Spain & Portugal	SPBO	116
30 Day The Best of Spain & Portugal + Amsterdam to Budapest Cruise	SPBC	119
22 Day Spain, Portugal & Morocco	SPPM	120
36 Day Spain, Portugal & Morocco + Amsterdam to Budapest Cruise	SPMC	123

## SCANDINAVIA + RIVER CRUISING & OCEAN CRUISING

	TOUR CODE	PAGE
13 Day Spectacular Scandinavia	SCNS	124
27 Day Spectacular Scandinavia + Amsterdam to Budapest Cruise	SCRC	127
21 Day Magnificent Scandinavia and Baltic Cruise	SCAN	128

# SUPERSAVER EARLYBIRD

BOOK\* BY 30 SEPTEMBER 2009

# EARLYBIRD SAVER

BOOK\* BY 30 NOVEMBER 2009

<b>FREE AIRFARE</b> JUST PAY TAXES FROM \$700 PER PERSON SAVE UP TO \$3790 PER COUPLE ALL DEPARTURES	<b>PARTNER</b> FREE AIRFARE JUST PAY TAXES FROM \$700 PER PERSON SAVE UP TO \$1895 PER COUPLE	<b>\$ DOLLAR</b> SAVING PER COUPLE	<b>SAVE</b> \$2000 PER COUPLE MAY TO SEPTEMBER DEPARTURES ONLY	<b>SAVE</b> \$1000 PER COUPLE	<b>\$ DOLLAR</b> SAVING PER COUPLE
E&D STATEROOMS ONLY EXCLUDES ITINERARIES CONTAINING A 7 NIGHT CRUISE	PRIVATE BALCONIES, JUNIOR & ROYAL SUITES	PRIVATE BALCONIES, JUNIOR & ROYAL SUITES ON TOURS COMBINED WITH A CRUISE	E&D STATEROOMS EXCLUDES ITINERARIES CONTAINING A 7 NIGHT CRUISE	PRIVATE BALCONIES, JUNIOR & ROYAL SUITES	PRIVATE BALCONIES, JUNIOR & ROYAL SUITES ON TOURS COMBINED WITH A CRUISE
×	×	\$760	×	×	\$760
✓	✓	×	✓	✓	×
×	×	\$680	×	×	\$680
✓	✓	×	✓	✓	×
×	×	\$1265	×	×	\$1265
✓	✓	×	✓	✓	×
×	×	\$860	×	×	\$860
✓	✓	×	✓	✓	×
✓	×	\$1000	✓	×	\$500
✓	✓	×	✓	✓	×
✓	×	\$1000	✓	×	\$500
×	×	\$1065	×	×	\$1065
✓	✓	×	✓	✓	×
×	×	\$920	×	×	\$920
×	×	\$1235	×	×	\$1235
×	×	\$425	×	×	\$425
✓	✓	×	✓	✓	×
×	×	\$750	×	×	\$750
✓	✓	×	✓	✓	×
×	×	\$800	×	×	\$800
✓	✓	×	✓	✓	×
×	×	\$1070	×	×	\$1070
✓	✓	×	✓	✓	×
×	×	\$780	×	×	\$780
✓	✓	×	✓	✓	×
×	×	\$1045	×	×	\$1045

✓ Applicable × Not Applicable Earlybird discounts cannot be combined

✓ Applicable × Not Applicable Earlybird discounts cannot be combined

\*AND PAY APPLICABLE DEPOSIT. STRICTLY LIMITED CABINS AVAILABLE ON SET DEPARTURES OR UNTIL SOLD OUT. PLEASE READ IN CONJUNCTION WITH SCENIC TOURS 2010 EUROPE BROCHURE. EARLYBIRD DISCOUNTS AND SUPER SEASONAL SPECIALS CANNOT BE COMBINED AND NO OTHER DISCOUNT APPLIES.

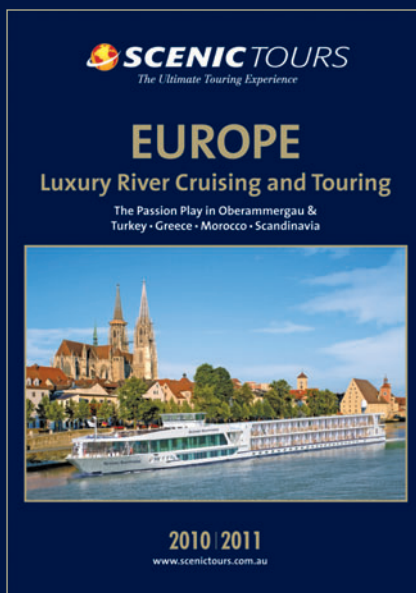

## Terms and Conditions Please read carefully before booking

**These terms and conditions are additional to the full terms and conditions contained in Scenic Tours Europe River Cruising and Touring 2010 brochure. All bookings are subject to Scenic Tours full terms and conditions.**

### **Earlybird One – Travel in 2010 for 2009 Prices**

Applies to any river cruise of 15 days and over and any river cruise of 15 days and over combined with land content. 2010 Cruise/Land content selected must be of the same duration and content as 2009 or surcharges may apply. Offer valid for all departures from April to October 2010. Advertised savings are calculated by using the maximum difference between 2009 and 2010. Offer expires on the 31 August 2009 or until sold out. Strictly limited staterooms/suites available on set departures and subject to availability. Offer cannot be combined with any other offer and may be withdrawn at any time. A non-refundable deposit of \$1000 is required within 7 days of booking. Full payment must be received by the 31 August 2009. Port charges from \$355 per person.

### **Supersaver Earlybird & Super Seasonal Specials**

#### **▲ Free Airfare to Europe**

Fly Free to Europe offer is available on selected departures as detailed in this publication. Fly Free is in economy class on an airline of Scenic Tours choice. A non-refundable deposit of \$3,000 per person is due within 7 days of booking. Scenic Tours reserve the right to ticket the airfare upon receipt of deposit. Offer available until 30 September 2009 or until sold out. For cruises and cruise and land packages accommodated in D and E Staterooms offer expires on 30 November 2009. Strictly limited staterooms/suites available on set departures and subject to availability. Offer cannot be combined with any other offer and may be withdrawn at any time. Flights are subject to availability of appropriate airline class and once sold out surcharges may apply. Airline/Airport taxes from \$700 per person are additional, subject to change and will be confirmed at the time of reservation. Flights must be booked by Scenic Tours.

#### **▲ Save up to \$3790 per couple**

Based on the average cost of 2 return economy class airfares to Europe of \$1895 each on Singapore airlines or an airline of Scenic Tours choice. Just pay taxes from \$700 per person.

#### **Supersaver Earlybird – † Partner Free Airfare to Europe**

Partner Free Airfare to Europe offer is available on selected departures as detailed in this publication. Partner Free Airfare is in economy class on an airline of Scenic Tours choice. To receive Partner Free Airfare the second airfare must be purchased with Scenic Tours at time of booking. A non-refundable deposit of \$3000 per person is due within 7 days of booking. Scenic Tours reserve the right to ticket the airfare upon receipt of deposit. Offer available until 30 September 2009 or until sold out. Strictly limited staterooms/suites available on set departures and subject to availability. Offer cannot be combined with any other offer and may be withdrawn at any time. Flights are subject to availability of appropriate airline class and once sold out surcharges may apply. Airline/Airport taxes from \$700 per person are additional, subject to change and will be confirmed at the time of reservation. Flights must be booked by Scenic Tours.

#### **‡ Save up to \$1895 per couple**

Based on the average cost of 1 return economy class airfare to Europe of \$1895 on Singapore airlines or an airline of Scenic Tours choice. Just pay taxes from \$700 per person.

#### **Supersaver Earlybird and Earlybird Saver – Dollar Saving Per Couple**

The Dollar Saving offers are available on selected departures as detailed in this publication. Please refer to relevant book by dates applicable to the cruise/tour of your choice. Offer cannot be combined with any other offer and may be withdrawn at any time.

#### **◆ Fly Business Class to Europe for \$2600**

Purchase a Royal Suite on an Amsterdam to Budapest River Cruise and receive an upgrade to Business Class for \$2600 per person. Offer is based on J Class Swiss and I Class Qantas ex. BNE/SYD/MEL/PER - surcharges apply from other ports. Must be booked and deposited by 30 September 2009. A non-refundable deposit of \$3000 per person is due within 7 days of booking. Scenic Tours reserve the right to ticket the airfare upon receipt of deposit. Taxes of \$613 per person are included. Taxes subject to change and will be confirmed at the time of reservation.

#### **◆ Fly Business Class to Europe for \$3600**

Purchase a Junior or Royal Suite on an Amsterdam to Budapest River Cruise and receive an upgrade to Business Class for \$3600 per person. Offer is based on J Class Swiss and I Class Qantas ex. BNE/SYD/MEL/PER - surcharges apply from other ports. Must be booked and deposited by 30 September 2009. A non-refundable deposit of \$3000 per person is due within 7 days of booking. Scenic Tours reserve the right to ticket the airfare upon receipt of deposit. Taxes of \$613 per person are included. Taxes subject to change and will be confirmed at the time of reservation.

#### **Free Two Night Asian Stopover**

Book a 21 Day Paris + Amsterdam to Budapest Cruise + Prague March or November departures and not only receive a Free Airfare to Europe (taxes additional from \$700 per person) but also receive a 2 night Asian stopover. March departures, book and pay in full by 30 November 2009. November departures, book and pay in full by 28 February 2010. Offer available for Singapore, Bangkok, Kuala Lumpur and Hong Kong. Offer is based on a first class hotel of Scenic Tours choice not including breakfast. Return airport transfers included in Asia.

#### **Taxes**

Taxes are defined as all airline and government taxes and surcharges.

## Direct Dial Australia Wide

RESERVATIONS AND ENQUIRIES

# 1300 136 001

LOCAL CALL COST

TRAVEL AGENTS: Log into Scenic Tours  
Express Book for live availability  
<http://bookings.scenictours.com.au>

Group Enquiries: 1300 655 112

## SCENIC Tours Contact Details

### Newcastle:

Level 2, 11 Brown Street,  
Newcastle, NSW 2300

Fax: (02) 4929 4943

email: [info@scenictours.com](mailto:info@scenictours.com)

### Sydney:

Level 14, 56 Pitt Street,

Sydney NSW 2000

email: [info@scenictours.com](mailto:info@scenictours.com)

### North America office:

Fairmont Hotel Vancouver  
Lower Level, 900 West Georgia St,  
Vancouver, BC V6C 2W6, Canada  
email: [canada@scenictours.com](mailto:canada@scenictours.com)

### UK office:

6th Floor, 111 Piccadilly,  
Manchester, M1 2HY,  
United Kingdom  
email: [ukoffice@scenictours.com](mailto:ukoffice@scenictours.com)

YOUR PROFESSIONAL TRAVEL AGENT: